

Quote



10' X 10' SAMPLE KITCHEN

PROJECT DETAILS

ID: DIY SALES

Creation date:

Dealer

Customer

Cabinet Warehouse

DESIGN DETAILS

File name: C:\Users\000003372\Documents\2020 Files\10'10' KITCHEN.kit

Reference:

Sold date:

Designer ID: _

Delivery date:

Designer name: French Point _

Installation date:

Sort order: Tall/Wall/Base

CATALOG KCDIY_21

Supplier

Cabinet Warehouse 5279 Still Creek Ave

Wall doors:

Tall doors:

Base doors: Salem Solid Maple

Drawer fronts:

Drawer pulls:

Door pulls:

Item	Qty	Description	Contempra White	Salem Solid Maple Cappuccino	Coventry Therm White
------	-----	-------------	-----------------	------------------------------	----------------------

Cabinets

1	1	Wall 33w 13.5h	213.00	275.00	300.00
2	1	Wall 24w-2 30h	204.00	263.00	287.00
3	1	Wall 30w 10.5h	185.00	236.00	256.00
3.1	1	Microwave/Hood			
4	1	Wall 12W 30h R	161.00	203.00	219.00
5	1	Wall Angular 21w 30h R	220.00	286.00	312.00
6	1	Wall 42w 30h	268.00	353.00	387.00
7	1	Base 24w Full Height	214.00	278.00	303.00
8	1	Base Corner Corner 33w Fh R	235.00	306.00	335.00
9	1	Base 33w Full Height	285.00	377.00	414.00
10	1	Base 30w Full Height	254.00	334.00	366.00
Cabinets total:			2,239.00	2,911.00	3,179.00
Cabinets net total:			2,239.00	2,911.00	3,179.00

Accessories

*11	17	SATIN NICKEL KNOB	51.00	51.00	51.00
-----	----	-------------------	-------	-------	-------

Item	Qty	Description	Contempra White	Salem Solid Maple Cappuccino	
			Coventry Therm White		
*12	15	STD KIT/VAN.BAR TOPS	450.00	450.00	450.00
*13	1	{ac} Corner Moulding 36	20.00	20.00	20.00
*14	1	{ac} Installation Kit	20.00	20.00	20.00
*15	2	{ac} Melamine Toekick 96w 4.5h	48.00	48.00	48.00
Accessories total:			589.00	589.00	589.00
Accessories net total:			589.00	589.00	589.00
KCDIY_21 total:			2,828.00	3,500.00	3,768.00
KCDIY_21 net total:			2,828.00	3,500.00	3,768.00

*: non-plan item

QUOTE SUMMARY

KCDIY_21 net total:	\$2,828.00	\$3,500.00	\$3,768.00
Quote total:	\$2,828.00	\$3,500.00	\$3,768.00
Quote net total:	\$2,828.00	\$3,500.00	\$3,768.00

Other information

Volume: 86.98

Weight: 7.00

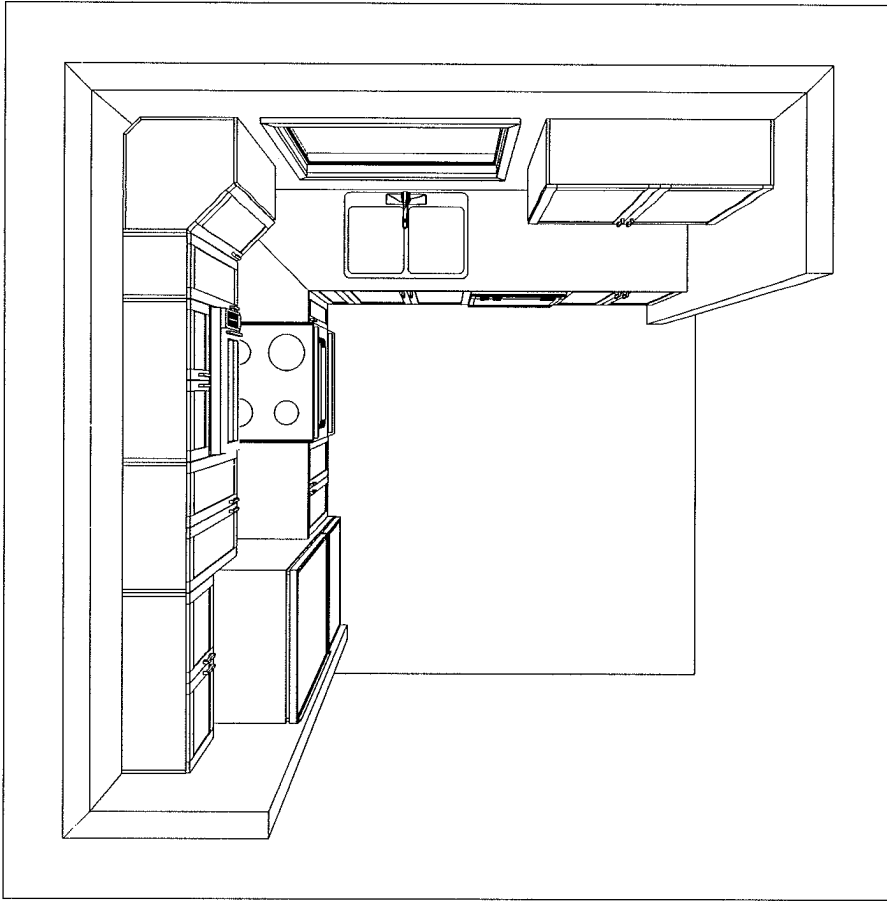

Note: This drawing is an artistic interpretation of the general appearance of the design. It is not meant to be an exact rendition.



Designed: 6/20/2015
Printed: 7/10/2015

10'10" KITCHEN.kit

All (no dims)

Drawing #: 1

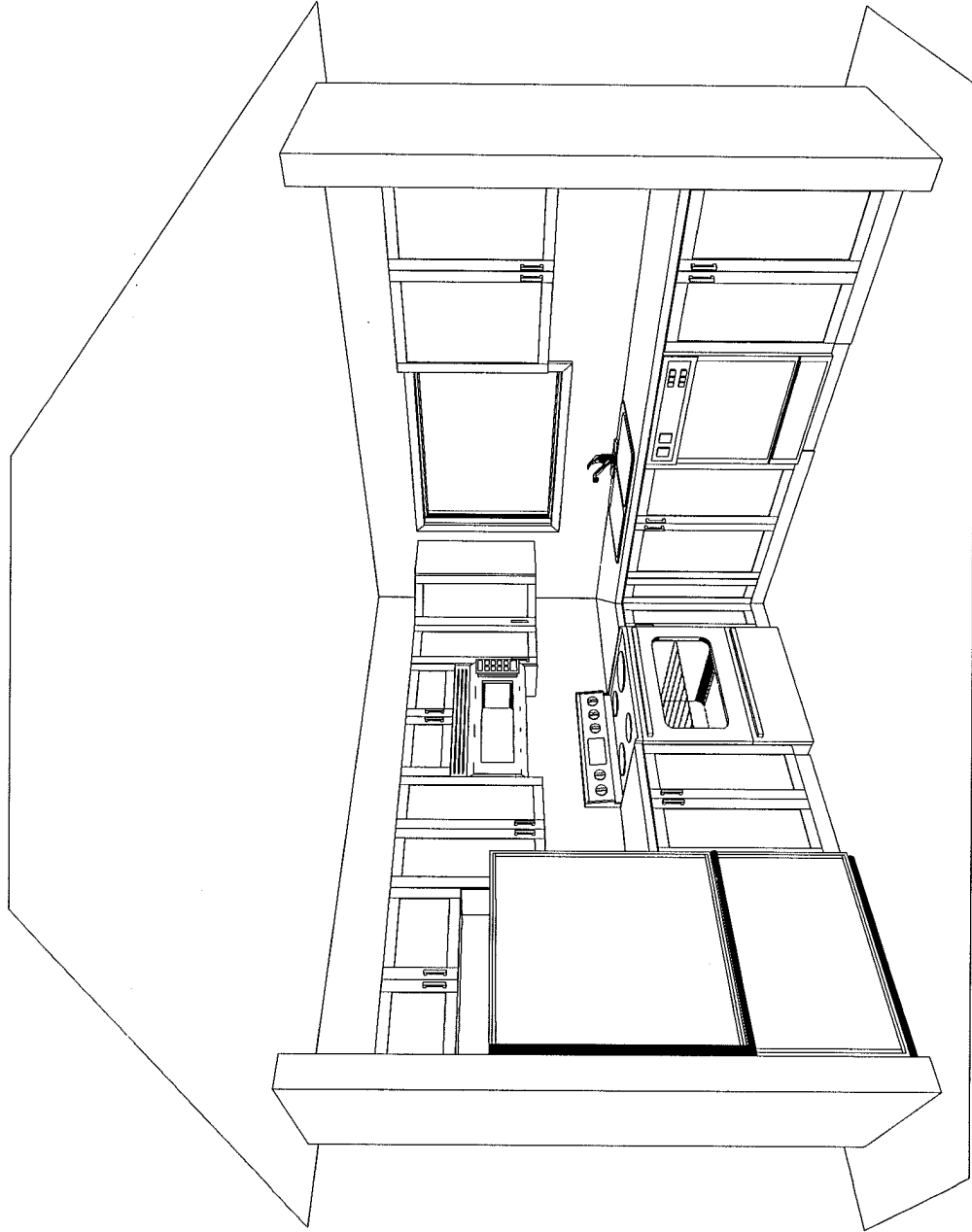

Note: This drawing is an artistic interpretation of the general appearance of the design. It is not meant to be an exact rendition.



Designed: 6/20/2015
Printed: 7/10/2015

10'10" KITCHEN.kit

All (no dims) Drawing #: 1

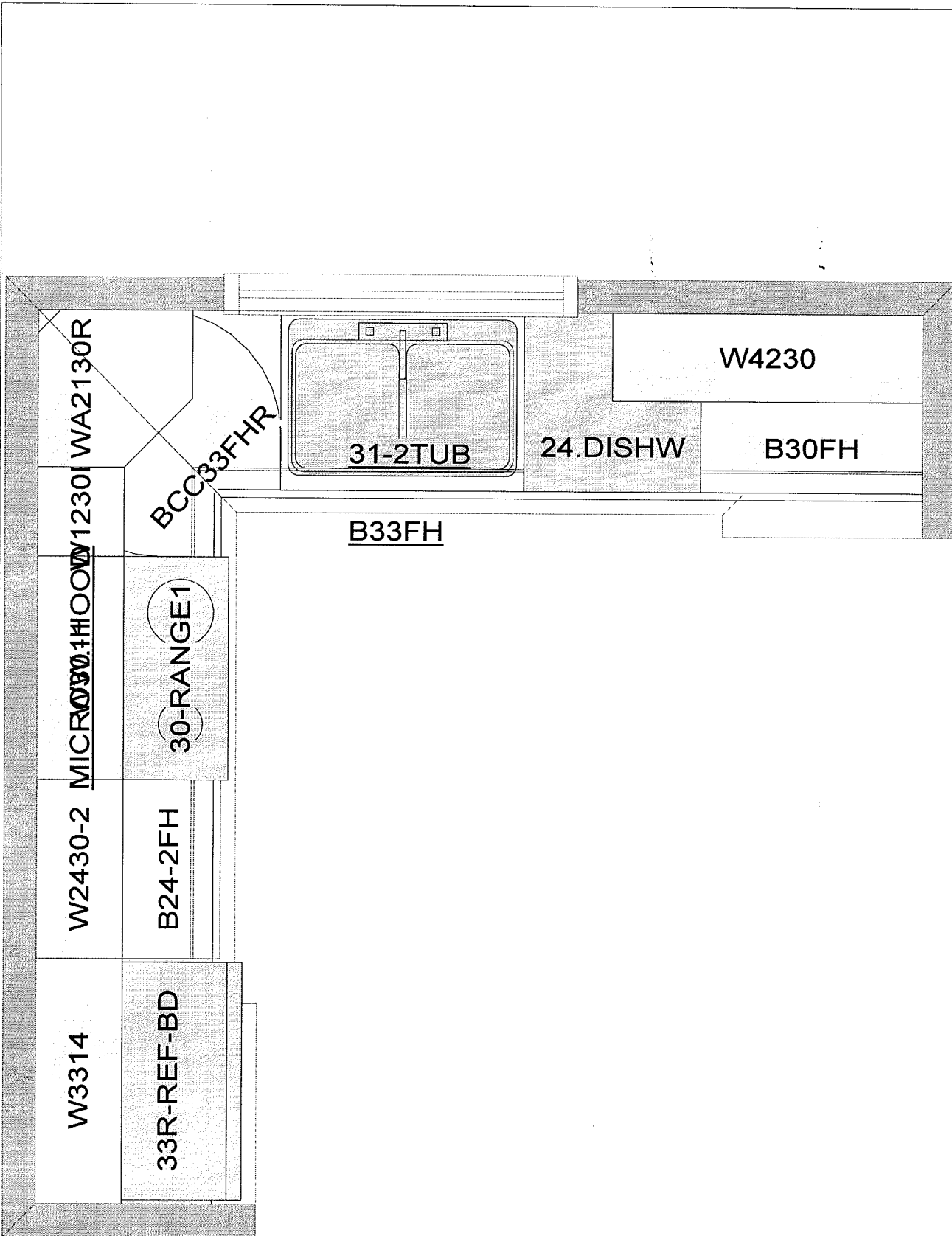

Designed: 6/20/2015
 Printed: 7/10/2015

This is an original design and must not be released or copied unless applicable fee has been paid or job order placed.

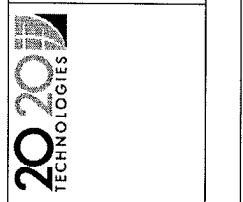

All dimensions -size designations given are subject to verification on job site and adjustment to fit job conditions.

All (no dims) Drawing #: 1 No Scale.

10'10" KITCHEN.kit